

WE KNOW CELL, WE KNOW YOU

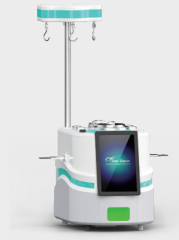

CELL-VOR
Automated Cell
Processing System

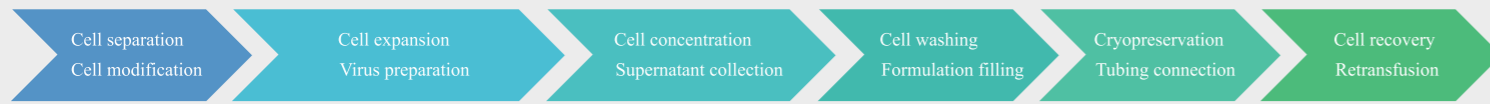

CELL-WAV
Automated Cell
Expansion System



Super CELL-VOR
Automated High Volume Cell
Concentration System



CELL-VOR
Automated Cell
Washing & Filling System



CELL-LAV
Sterile Tubing Welder



CELL-COL
Automated Cell
Recovery System

Sino-Biocan

CELL-VOR

Automated
Cell Processing System



Sino-Biocan (Shanghai) Biotech Ltd

Tel:021-60890755 / 4000056700

E-mail:info@sinobiocan.com

Website:www.sinobiocan.net

Address: 2nd Floor, Building 15, No. 6055, Jinhai Road,
Fengxian District, Shanghai

Sino-Biocan Biotech (Shanghai) Ltd

Tel:021-60890755 / 4000056700

E-mail:info@sinobiocan.com

Website:www.sinobiocan.net

Address: 1st Floor, Building 15, No. 6055, Jinhai Road,
Fengxian District, Shanghai

Sino-Biocan (Chengdu) Biotech Ltd

Tel:028-85840406 / 85893618

E-mail:info@sinobiocan.com

Website:www.sinobiocan.net

Address:4th Floor, Building 4, Tianfu International Biology City,
No.618, Fenghuang Road, Shuangliu District, Chengdu



Sino-Biocan (Shanghai) Biotech Ltd



Sino-Biocan

Sino-Biocan (Shanghai) Biotech Ltd is an automated, modularized, closed cell production platform provider in cell & gene therapy field, providing total solution of smart tools innovation and service, devoting to be the industry leader integrating R & D, business development, technical service, customization and production.

Sino-Biocan has developed a GMP-grade product family of fully closed, modularized, continuous cell preparation tools, as well as consumables and liquid solution, covering processes such as automated cell separation, culture, cell concentration, washing and formulation filling, cryopreservation and recovery, etc. Meanwhile it can provide modular splicing of different GMP processes, aiming to provide rapid, efficient and differentiated customization of series products of cell preparation tools.

Adhering to the principle of cooperation and originality on the way of exploration, Sino-Biocan carried out project cooperation with more than ten universities, medical institutes and scientific research institutes, such as Tsinghua University, Tongji University, and constructed multi-field postdoctoral mobile stations and expert workstations. Sino-Biocan has been cooperating with Chinese Society of Blood Transfusion to explore the latest research fields of cell preparation technology and application, signed strategic cooperation agreements with dozens of middle

and downstream enterprises in the industry, cooperated with more than 100 original cell and gene drug developers and CDMO companies. At present, the company has obtained more than 50 patents and trademark certificates independently, and started international PCT application. Sino-Biocan highly values construction of high quality standards, and has obtained ISO9001 and ISO13485 certification and submitted CE and NMPA applications.



Equipment Clean Workshops

Cell Separation System,
Cell Expansion System,
Cell Concentration System,
Cryopreservation System,
Cell Recovery System, etc

Annual output: 3000 units



GMP Consumable Workshops

Disposable Cell Separation Kit
Cryobag
Disposable Cell Expansion Kit
Cell Magnetic Separation Column

Annual output: 200,000 sets



GMP Liquid Product Workshops

Cell Culture Medium
Cell Cryopreservation Medium
Cell Magnetic Beads

Annual Output: 600,000 bottles



	Automated Cell Processing System	Automated Cell Separation System	Automated Cell Washing & Filling System
PBMC Separation	✓	✓	○
Cell Concentration	✓	○	✓
Cell Washing	✓	○	✓
Formulation filling	✓	○	✓

Applications: separation of peripheral blood mononuclear cells, cord blood stem cells, bone marrow stem cells; cell concentration, dilution, washing, formulation filling and magnetic beads incubation, etc.

Disposable closed consumables and automated control system provide customized biomanufacturing solutions of different cellular therapy products based on customer's specific requirements.

01

Disposable closed consumables provide bag-to-bag solution, avoiding pollution risks in open operation.

02

Bigger centrifugal chamber processes bigger volume in one batch, better separation results.

03

Equipment comes with supported consumables, high cost performance and compatibility, short and stable delivery, customization based on request.

04

Flexible combination of modularized parameters, key parameters can be customized, high process compatibility.

05

3Q document is available to ensure design requirements and functional requirements are met.

06

All the data can be saved, queried, traced and output, meeting demands of access management and electronic signature, compliant with GMP standards.

07

Professional technical and after-service team, respond within 24 hours.

08

Compatible with Sino-Biocan cell expansion system and high volume cell concentration system, forming a comprehensive product line.

PRODUCT COMPOSITION

CELL-VOR Automated Cell Processing System

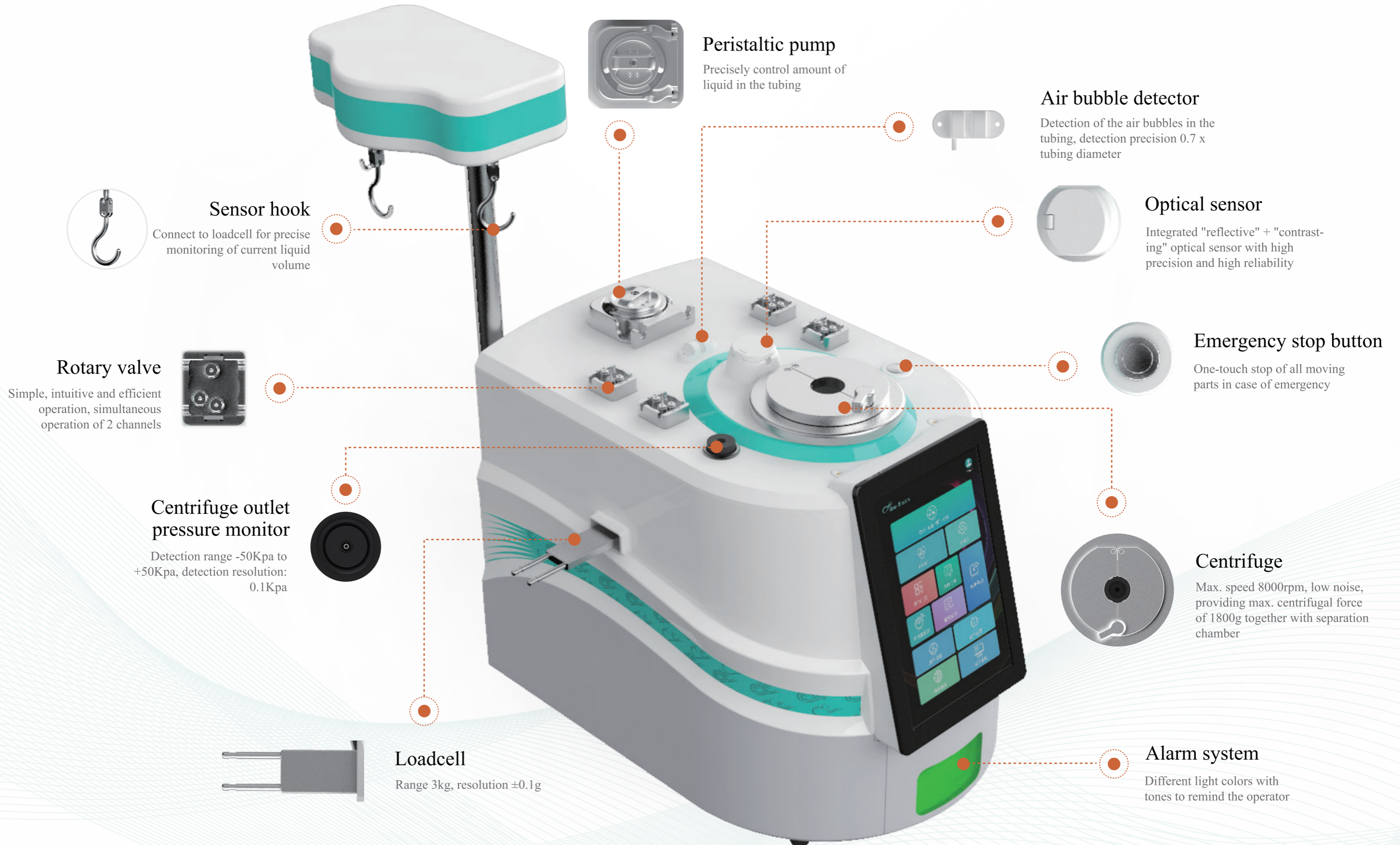

A. PBMC Separation

Centrifugal chamber volume	300ml
Separation Principle	Ficoll density gradient centrifugation
Recovery rate	PBMC Recovery rate \geq 50%
Cell viability loss	<5%
Red blood cell removal rate	>99%
End product volume	30-150ml

* Above data is only for reference, actual results may vary in specific process

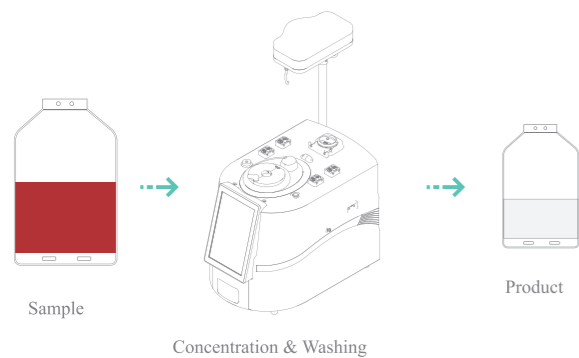
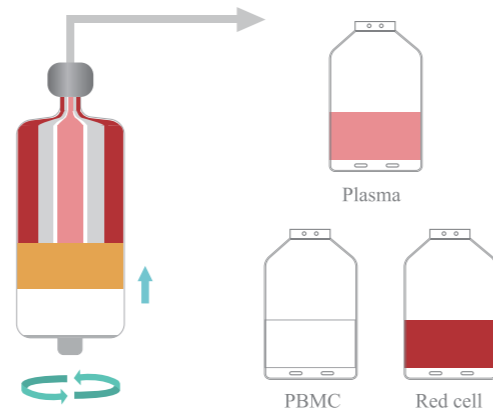

B. Cell Concentration and Washing

Centrifugal chamber volume	300ml
Sample volume	30-2000ml
End product volume	20-280ml
Recovery rate	\geq 85%
Cell viability loss	<5%

* Above data is only for reference, actual results may vary in specific process

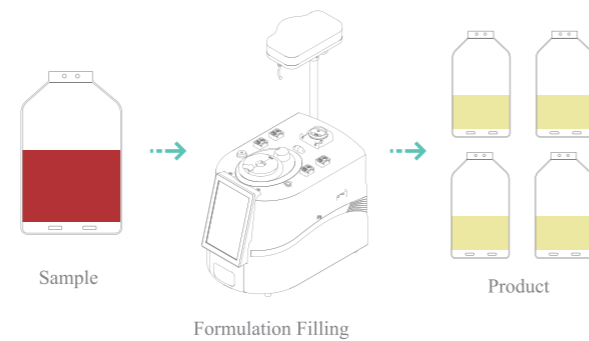

C. Cell Formulation Filling

Centrifugal chamber volume	300ml
Filling method	Direct filling/ A+B filling
Filling volume	\geq 20ml
Filling type	Filling based on different volume Filling based on different density
Recovery rate	\geq 90%
Cell viability loss	<5%

* Above data is only for reference, actual results may vary in specific process

ITEM

PARAMETER

Dimension	416×679×635mm
Power	<30kg
Max. Centrifugal force	1230g
Centrifugal chamber dynamic volume	300ml
Peristaltic pump	10-200 rpm
Noise	\leq 62 db
Environmental requirements	+10°C~+30°C

ORDER INFORMATION

PART NO.	MODEL	DESCRIPTION
HH-CV80-1S	CV80-1S	CELL-VOR Automated Cell Separation System
HH-CV80-2S	CV80-2S	CELL-VOR Automated Cell Washing & Filling System
HH-CV80-3S	CV80-3S	CELL-VOR Automated Cell Processing System
HH-CV80-03	CV80-03	CELL-VOR Disposable PBMC Cell Separation Kit
HH-CV80-04	CV80-04	CELL-VOR Disposable Cell Washing & Concentration Kit
HH-CV80-05	CV80-05	CELL-VOR Disposable Cell Formulation Kit

